

Nikon

Downloading Optional Picture Controls for the D300

—Macintosh—

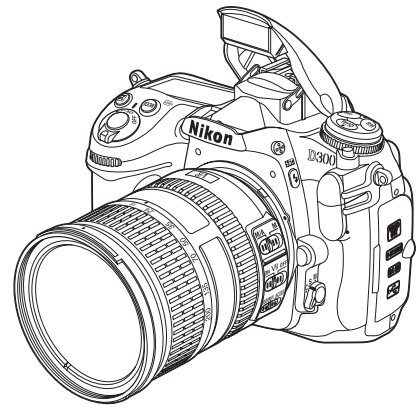

Thank you for choosing Nikon. This guide describes how to download and install the following optional Picture Controls for the D300: D2XMODE1, D2XMODE2, and D2XMODE3.

The steps involved in downloading and installing optional Picture Controls are outlined below:

- 1 Get ready pg. 2**
Ready the equipment required to copy the Picture Controls to the camera.
- 2 Download and extract the D300 Picture Controls pg. 2**
Download the optional Picture Controls from a Nikon website.
- 3 Copy the Picture Controls to a memory card pg. 2**
Copy the optional Picture Controls to a memory card.
- 4 Copy the Picture Controls to the camera..... pg. 4**
Copy the optional Picture Controls to the camera.

System Requirements

Before downloading optional Picture Controls, be sure your system meets the following requirements:

OS	Mac OS X 10.3.9 – 10.4.10.
CPU	Power PC G4/G5, Intel Core Solo, Intel Core Duo, Intel Core 2 Duo, Intel Xeon
Hard-disk space	5 MB free
RAM	32 MB
Miscellaneous	Built-in USB port required

1 Get ready

To copy optional Picture Controls to the camera, you will need:

- The camera
- A UC-E4 USB cable
- One of the following power sources:
 - ◆ An EH-5a or EH-5 AC adapter
 - ◆ A fully-charged EN-EL3e rechargeable Li-ion battery
- A Nikon-approved memory card
- The camera manual

2 Download and extract the D300 Picture Controls

Click the “I agree - Begin download” link on the download site and download a disk image file containing the D2X mode Picture Controls to the desktop. Once download is complete, double-click the disk image to mount the volume and display a “NIKON” folder containing the optional Picture Controls “D300__M1.NOP,” “D300__M2.NOP,” and “D300__M3.NOP.”



3 Copy the Picture Controls to a memory card

Optional Picture Controls can be copied to a memory card when the camera is connected to the computer using the USB cable.

Note: Use an EH-5a or EH-5 AC adapter or a fully-charged EN-EL3e rechargeable Li-ion battery.

- 1 Turn the camera off and insert a memory card.
- 2 Turn the camera on and press the **MENU** button to display the camera menus. Navigate to the setup menu and select **Format memory card**. The dialog shown at right will be displayed; highlight **Yes** and press **OK** to format the memory card.

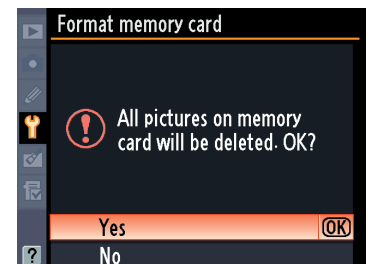

- 3 Press the **MENU** button and select **Mass Storage** for the **USB** option in the setup menu.

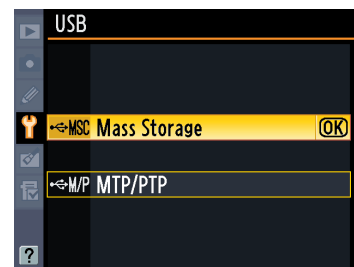

- 4 Turn the camera off and connect the USB cable as shown.

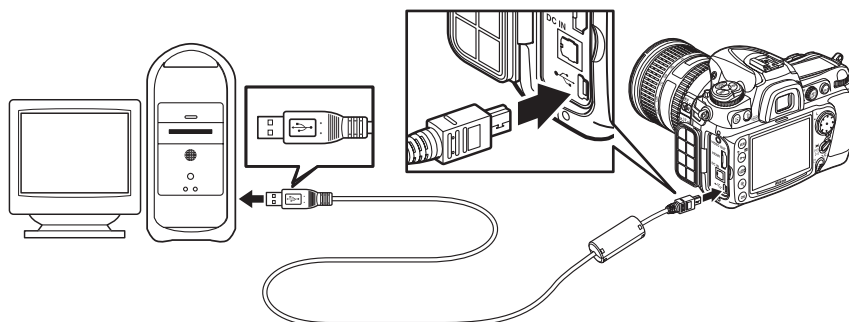

- 5 Turn the camera on. If Nikon Transfer is installed, it will start automatically; exit Nikon Transfer before proceeding.
- 6 A volume corresponding to the camera will appear on the desktop. Copy the "NIKON" folder from the disk image created in Step 2 to the camera volume.

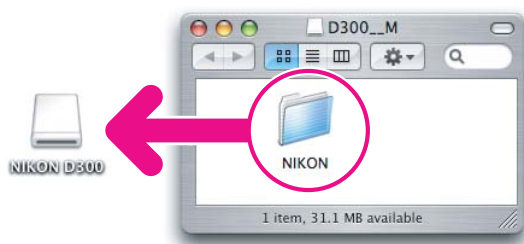

Important

Copy the "NIKON" folder directly to the top (root) level of the camera volume. The camera will not recognize the optional Picture Controls if the "NIKON" folder is inside another folder.

When copying is complete, open the "NIKON" folder on the camera volume and confirm that it contains the optional Picture Controls "D300___M1.NOP," "D300___M2.NOP," and "D300___M3.NOP."

Note: The number of exposures remaining will decrease when optional Picture Controls are copied to the memory card.

- 7 Disconnect the camera from the computer. For more information, see the camera manual.

4

Copy the Picture Controls to the camera

- 1 Turn the camera on.
- 2 Press the **MENU** button and select **Load/save** for the **Manage Picture Control** option in the shooting menu.
- 3 Select **Copy to camera**.
- 4 Highlight an optional Picture Control and press **OK**.
- 5 Highlight a destination for the optional Picture Control and press **OK**. Any Picture Control currently stored in the selected destination will be overwritten.

Settings for the optional Picture Control can be viewed using the **Save/edit** option in the **Manage Picture Control** menu. See the camera manual for details.

- 6 Repeat steps **4-2** to **4-5** to copy additional optional Picture Controls to the camera.

This completes the process of downloading and installing optional Picture Controls.

